

Entry 7755
 Approved ✓
 Date Feb 3 32.00
 FILED FOR
 FRANKLIN KELLER & NEKEN
 APR 23 11 54 AM '85
 BOOK 4 OF PLATS
 PAGE 363
 ANN O'BRIEN
 COUNTY CLERK

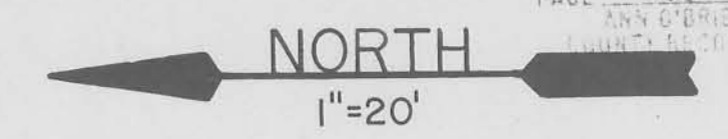

SURVEYOR'S CERTIFICATE

I, BRUCE T.S. WARE DO HEREBY CERTIFY THAT I AM A REGISTERED LAND SURVEYOR, AND THAT I HOLD CERTIFICATE NO. 4502, AS PRESCRIBED UNDER THE LAWS OF THE STATE OF UTAH, I FURTHER CERTIFY THAT BY AUTHORITY OF THE OWNERS, I HAVE MADE A SURVEY OF THE TRACT OF LAND SHOWN ON THIS PLAT AND DESCRIBED BELOW, HEREAFTER TO BE KNOWN AS RECORD OF SURVEY MAP OF

VALLEY VIEW MEDICAL OFFICE

A UTAH CONDOMINIUM PROJECT
 MAP 1 OF 2

DESCRIPTION

BEGINNING AT A POINT 1252.00 FEET NORTH AND 16.37 FEET EAST OF THE SOUTHWEST CORNER OF SECTION 17, TOWNSHIP 14 SOUTH, RANGE 10 EAST, SALT LAKE BASE AND MERIDIAN, SAID BEGINNING POINT IS ON THE EAST RIGHT OF WAY OF COUNTY ROAD; THENCE

COURSE	DISTANCE	REMARKS
N 0°30'40"W	243.04	FEET ALONG SAID COUNTY ROAD TO THE INTERSECT WITH THE WEST EDGE OF THE COUNTY HIGHWAY, THENCE
N 89°29'20"E	60.68	FEET ALONG SAID COUNTY HIGHWAY, THENCE
SOUTHEASTERLY	218.22	FEET ALONG SAID COUNTY HIGHWAY ALONG A NORMAL CURVE TO THE RIGHT WITH A 676.2 FT. RADIUS, CENTRAL ANGLE 18°29'26"
S 16°47'50"E	116.80	FEET ALONG SAID COUNTY HIGHWAY, THENCE
S 73°12'10"W	50.00	FEET, THENCE
NORTHWESTERLY	141.76	FEET ALONG A NORMAL CURVE TO THE LEFT WITH A 110.00 FT. RADIUS, CENTRAL ANGLE 73°42'50", THENCE
S 89°29'20"W	33.50	FEET MORE OR LESS TO THE POINT OF BEGINNING.

CONTAINING 0.76 ACRE, SITUATED IN CARBON COUNTY, UTAH.



Feb. 11, 1985
 DATE

Bruce T.S. Ware

OWNER'S DEDICATION

KNOW ALL MEN BY THESE PRESENTS THAT the undersigned, THE 4 UNDERSIGNED OWNER(S) OF THE ABOVE DESCRIBED TRACT OF LAND, HAVE CAUSED A SURVEY TO BE MADE AND THIS RECORD OF SURVEY MAP CONSISTING OF 2 SHEETS TO BE PREPARED DO HEREBY GIVE OUR CONSENT TO THE RECORDATION OF THIS RECORD OF SURVEY MAP AND SUBMIT THIS PROPERTY TO THE UTAH CONDOMINIUM OWNERSHIP ACT.

IN WITNESS WHEREBY the undersigned HAVE HEREUNTO SET our hands THIS 11 DAY OF Feb A.D. 19 85.

James H. Wood
James H. Wood
James H. Wood
James H. Wood

ACKNOWLEDGMENT

STATE OF UTAH _____ S.S.
 County of _____
 On the _____ day of _____ A.D. 19 _____, personally appeared before me,

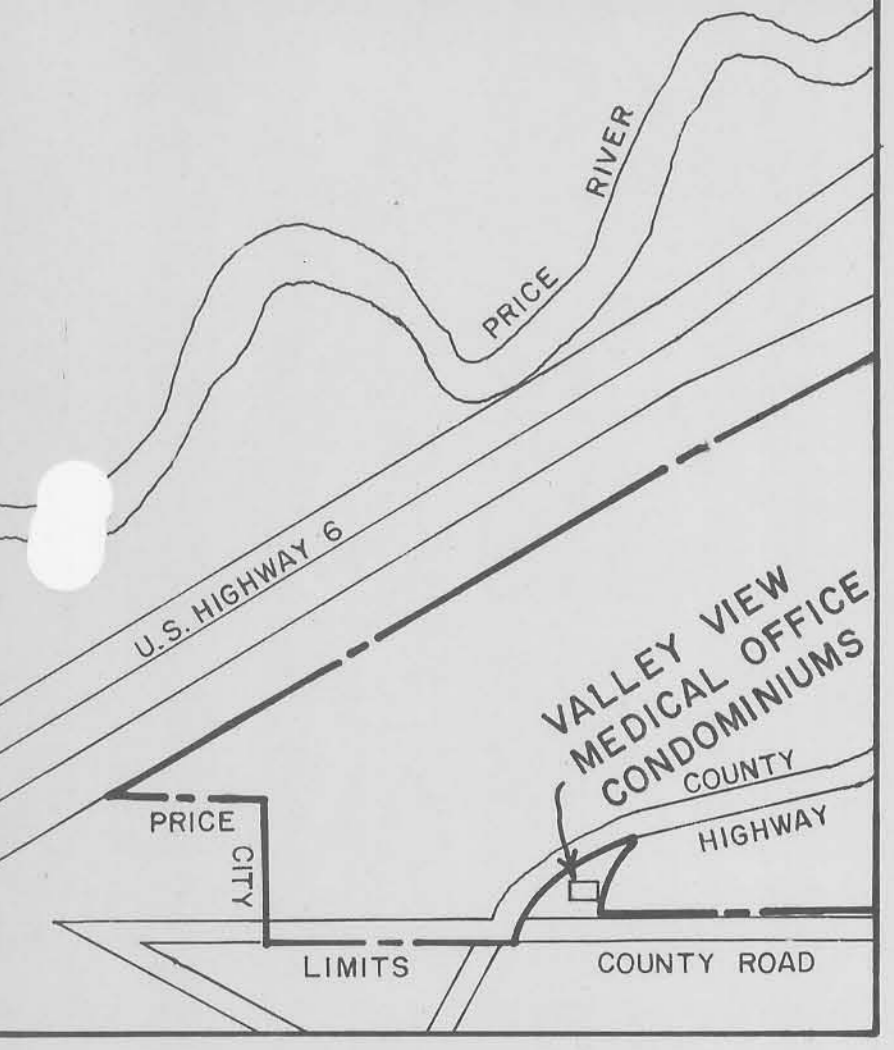

VICINITY MAP

